

USER INSTRUCTIONS

Revolution ECO 16 Bay Trolley™
Revolution ECO 28 Bay Trolley™



www.pclocs.com.au

www.lockncharge.com

Congratulations on your purchase.

Follow these instructions for easy and fast set-up of your Revolution ECO Trolleys.

PC Locs, LocknCharge and the Padlock device are Trademarks of IWS Global Pty Ltd.
Copyright IWS Global Pty Ltd, May 2014.

Disclaimer.

This information is the intellectual property of IWS Global Pty Ltd and may not be distributed, duplicated or copied in part or full without the written permission. Since the use of this information, the equipment connected and the conditions by which any IWS Global product is used is beyond the control of IWS Global, it is the obligation of the owner and/or user to determine the correct and safe use of any equipment and product. To the extent that the law permits, any liability which may be incurred as a result of the use or future use of a product manufactured or sold by IWS Global is limited to the cost of repairing or replacing the failed product or component at the discretion of IWS Global either within, or outside of warranty periods, and does not extend to any loss or damage which may be caused as a consequence of misuse or failure of the equipment or product or the information contained herein. IWS Global shall not in any event be liable for economic loss of profits, indirect, special, bodily injuries or consequential damages.

Extra Tools required:**Hammer, Philips head screwdriver, medium adjustable spanner. (Allen key supplied)***(Panel colours for illustration purposes only)*

Unpack the trolley

The boxes in the top of the Trolley contain the wheels and fittings.

Standard castors



PU Wheels (optional)



Weather cover (optional)



Attach Castors

On a carpeted surface turn the trolley upside down. Insert castor wheels into the leg ends and ensure the threaded hole in the castor wheel post lines up with the hole in the trolley leg. Screw in the socket screw with a flat washer and a spring washer using the Allen Key.

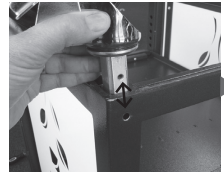

Fit the ECO power board side panel (16 bay trolley)

Slide the panel up and under the top rail on the side of the trolley that has the large power board opening.

Using the small bolts and washers secure the panel from the inside of the trolley using the Allen Key (2 in the top of the panel and 2 in the bottom)



Fit the other side panel to the trolley using the same technique. Lift one end of the adjustable shelf up off its support bar and remove the bar. Carefully let that end of the shelf down.



Repeat the process the other end of the shelf, so that the shelf unit is in the bottom of the trolley frame. Fix the last 2 Allen screws to the middle of each colour side panel from inside the frame.

Insert the 4-way Power Boards

Press the powerboards into the clips in the tray top. If a powerboard is loose in its clip, remove power board then slightly squeeze the clip sides together and refit the board

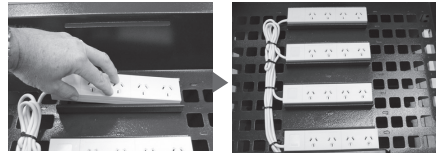

Insert the plugs through the hole in the end of ECO board bracket and out through coloured side panel square holes.

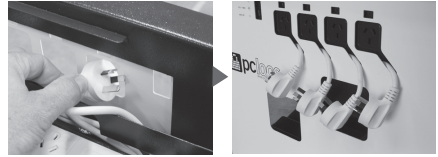

Insert the ECO Safe Charge™ power board(s)

Insert the ECO Safe Charge™ power board in the bracket located on the inside of the top tray. The plug exits the frame through the adjacent square hole. The four plugs can then be plugged into the ECO board.

Use the cable ties to tidy up the leads.



Fix the adjustable laptop shelf

The fixings kit includes the 'hammer-in' security pins and a punch bar.

Turn the trolley right side up. Using a Philips head screwdriver remove the shipping screws from both sides of the adjustable shelf unit.

Unpack the 'COLOUR PACK' - trolley lid, side panels, locking bars, and fixings kit. **Note: for 16 bay only (28 bay panels come installed)**

Find the correct height for the shelf by sliding one of the laptops you intend to use into the trolley.

Adjust the shelf height as determined by the size of your laptop. Refit the shelf support bar to both sides of the trolley frame and ensure the holes in the bar are facing outwards to line up with the holes in the edge of the shelf unit. Refit the laptop into the shelf, with the charging lead plugged in, and check there is sufficient clearance for the laptop to slide in and out easily. A closer fit means better laptop security.

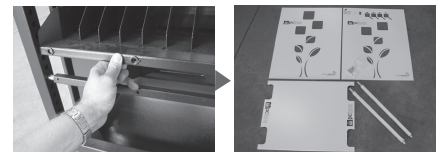
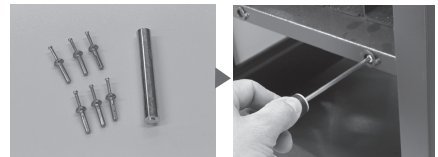

Fix the adjustable laptop shelf (continued)

Check that the shelf is fitted level in the trolley frame by counting the same number of locating holes above the fitted shelf on each leg (there is an extra hole on the bottom of one side for the lock pin). Check that the holes in the shelf and the support bars line up by slightly lifting the shelf off the bar.

Check again that your test laptop fits in the shelf unit in ALL bays with its charge lead attached.

ONCE THE SHELF IS FIXED IT IS IMPOSSIBLE TO ADJUST THE HEIGHT.

Insert the M5 x 25mm Metal Fixing Pins into each of the fixing holes on the shelf ends. Push them all the way in until the shoulder of the pin is hard up against the frame. Now using the supplied punch and your hammer, punch the pin all the way in. It is designed to spread out inside the trolley frame to prevent removal. Repeat the process with all of the fixing holes.

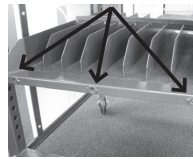
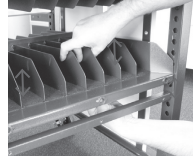

Locking the trolley

The locking bar should be positioned in the shelf about midway to ensure that the laptops cannot be removed. Use a marker pen on the frame to indicate which holes should be used for the locking bar each time. Use the supplied padlocks to secure the locking bar. Keep the keys in a secure place.



Install the bottom tray

Slide tray in from one end. Ensure tray sits flat



Installing the lockable lid

On a clean surface place the lockable lid upside down. Disassemble the cam lock as shown.



Insert the Cam Lock from the underside with the lock cam facing in the correct direction.



Now fit the locking nut over the main shaft of the cam lock and tighten using your spanner. **DO NOT OVER TIGHTEN** as this may distort the lid.

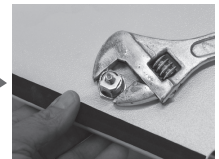

Installing the lockable lid (continued)

Fit the lock tongue as shown

Fit the small washer and M6 nut over the lock tongue and tighten. **DO NOT OVER TIGHTEN** to avoid stripping the thread.

Turn the Lockable Lid right way up. The keyway should be pointing to the left and the lock tongue pointing out from the lid. This is the 'locked' position.

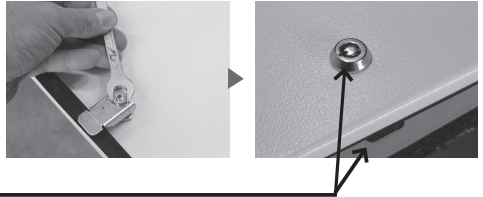

Test the locking mechanism by inserting the key and turning in a clockwise direction. This is the unlocked position. The lid can now be fitted to the trolley by sliding the non-lock end into the bracket at the end of the trolley top and lowering the lock end of the lid onto the bracket.

Install the Security Chain Kit

Tools required:

- > Masonry hammer-drill
- > 10mm masonry drill bit
- > Pencil and ruler/tape
- > Hammer
- > 13mm and 17mm spanners
- > The PC Locs 'RR Security Chain Kit' containing the following:
 - 1 x 3 holed Anchor Plate and security chain
 - 3 x 55mm long, 8mm Anchor Bolts
 - 3 x Shear Nuts and washers
 - 1 x BSD Lock and key set

Wheel your PC Locs RR Trolley to the location in which you intend to store and secure it. Ensure that the trolley (and chain) will reach the intended Floor Plate location. It is best if the Floor Plate is located as close as possible to a vertical wall to reduce the hazard of personal injury. Insert the pin end of the chain in the trolley and position the plate end in the desired position on the floor. **NOTE: If mounting on carpet you will need to cut out the carpet from the area where the floor plate attaches**

Mark the centre of each of the 3 holes.

Drill a 10mm hole through each of the 3 marked centres to a depth of 50mm, using the floor plate as a guide.

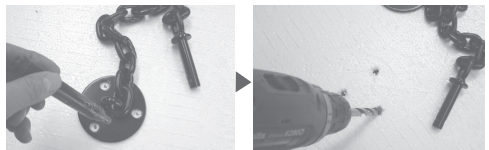

Insert the anchor bolts with nut attached into the holes through the floor plate. Using the 13 mm spanner, progressively tighten down each of these anchor nuts so that all three bolts are firmly anchored into the concrete.

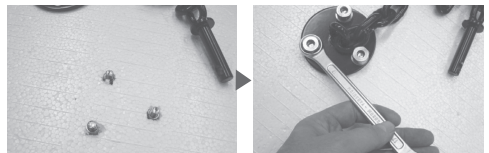

Now undo each of the three nuts, and in their place thread on the three silver shear-nuts. Ensure that the 'cone' is down and the hexagonal nut is up. Using the 17mm spanner tighten down the three shear nuts until the hexagonal 'head' shears off, leaving just the cone 'base'.



Installing the Security Chain Kit (continued)

Slide the security pin through the hole in the Leg of the RR Trolley and secure the pin using the PC Lock padlock.

The trolley is now secured and should be secured in this way at the end of every school day.

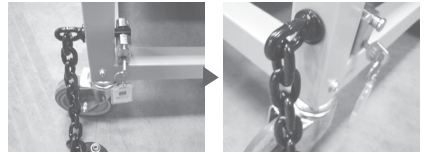

Fitting Instructions for Weather Cover

Using the Allen Key loosen the bolts that secure the coloured cleat. Remove one bolt completely.

Cleat



Bolt (inside trolley)

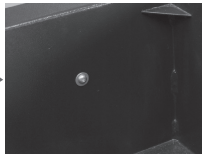

Loosen Bolts

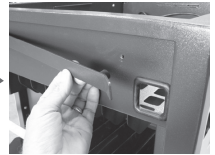
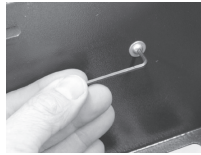

Slide the sleeve on the rear of the Weather Cover bag over the cleat.

Re-secure the cleat using the small bolts.

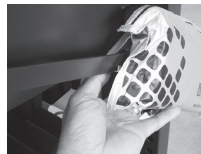

Unzip the bag and install the Weather Cover bag over the Trolley Frame.

NOTE: It is recommended the Weather Cover be rolled up and packed into the bag when the laptops are being charged in the trolley.

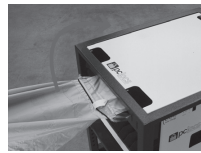

Congratulations!

Your Revolution Range® ECO Laptop Trolley is now ready for use.

For charging purposes read the instructions of how to use the ECO Safe Charge Power board.

Warranty

PC Locs/LocknCharge warrants the product to be free of defects in design, materials, assembly and craftsmanship for a period of twelve months from the date of purchase to the original retail purchaser. Evidence of original purchase will be required to obtain warranty service.

In the event that a defect, malfunction or failure occurs or is discovered during the warranty period, PC Locs/LocknCharge will repair or replace, at its option, the products which in the reasonable judgment of PC Locs/LocknCharge are deemed defective. All transportation costs shall be borne by the owner and the risk of loss shall be upon the party initiating the transportation.

The warranty does not apply to any product that has been subject to misuse, tampering, neglect, or accident or as a result of unauthorized alterations or repairs to the product. The warranty is in lieu of all warranties expressed or implied, including the implied warranties of merchantability and fitness for a particular purpose which are expressly excluded or disclaimed. In no event will PC Locs/LocknCharge, their directors, officers, employees, or agents be liable for any harm, consequential, incidental, third party, special or indirect damages whatsoever arising out of the use or inability to use the products even if PC Locs/LocknCharge has been advised of the possibility of such damages. PC Locs/LocknCharge obligation is strictly and exclusively limited to the replacement or repair of any defective products. Some states do not allow the exclusion or limitation of incidental or consequential damages, so the above limitation or exclusion may not apply to you.

Compliances and Approvals

